

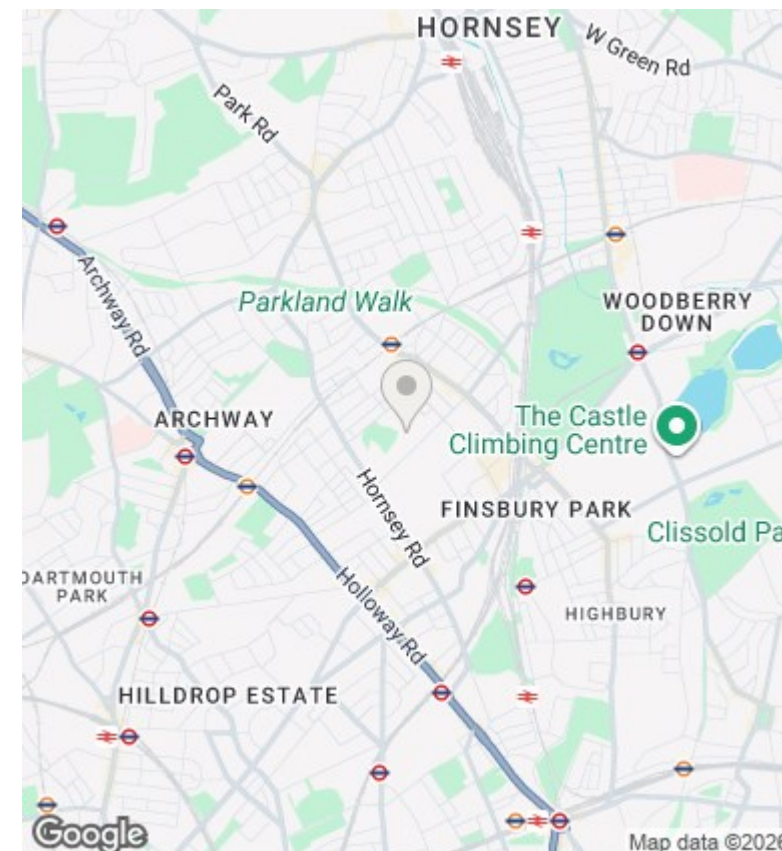

Turle Road, London, N4 3LZ

£1,850 PCM

- Managed by Simon Clarke Letting Agents
- Located an equidistance of 0.6 miles to both Crouch Hill & Finsbury Park Stations
- Council tax band D
- Available on long term tenancy
- 2 Double bedroom 2nd Floor flat set within a period conversion
- Situated on the doorstep of Wray Crescent Open Space & a short walk to Finsbury Park
- Unfurnished
- ***PROPERTY TO HAVE NEW FITTED CARPETS THROUGHOUT***
- Wooden venetian blinds
- Available from 9th April 2026

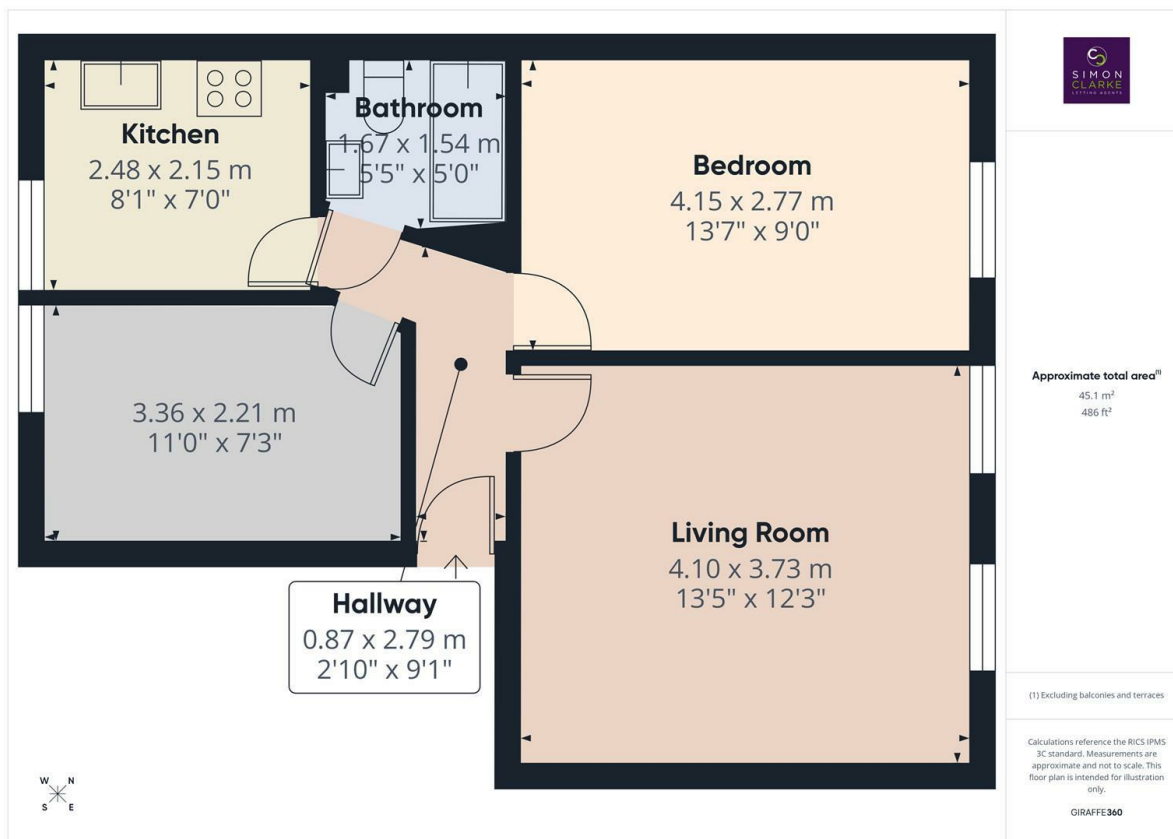

Directions

Viewings

Viewings by arrangement only. Call 02083499000 to make an appointment.

Council Tax Band

D

EPC Rating:

C

Energy Efficiency Rating		
	Current	Potential
Very energy efficient - lower running costs		
(92-plus) A		
(81-91) B		
(69-80) C	78	81
(55-68) D		
(39-54) E		
(21-38) F		
(1-20) G		
Not energy efficient - higher running costs		
England & Wales	EU Directive 2002/91/EC	